



MADE
IN
GERMANY



EPS HoopStation Assembly

Alternative assembly

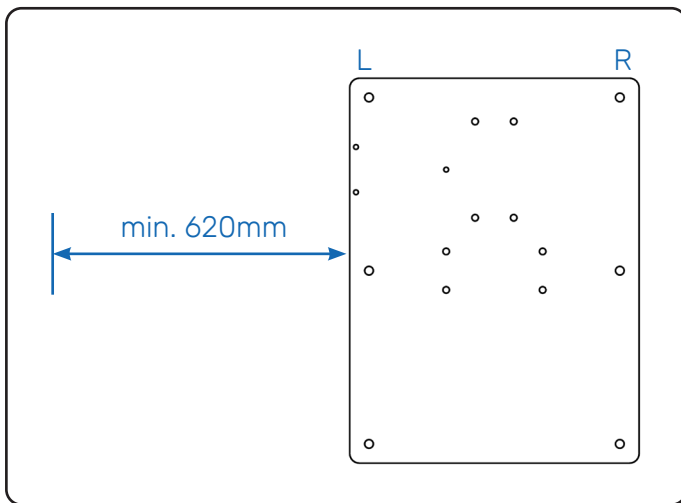

STEP1
Place the base on the table as indicated. Leave at least 620mm to the left side of the table.

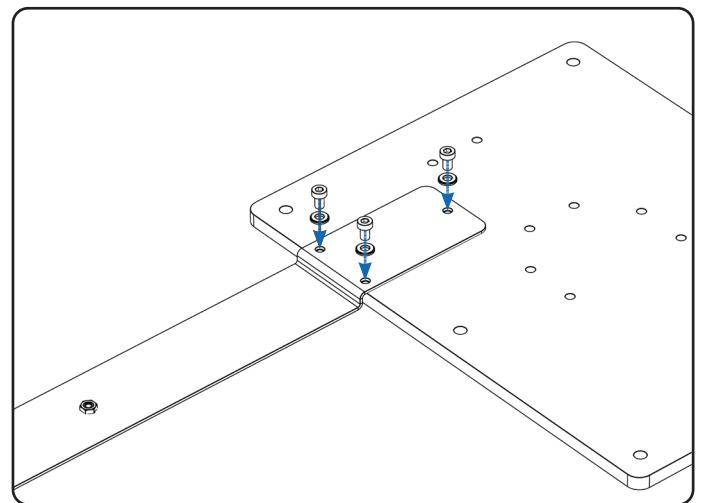

STEP2
Screw the connection with the help of the enclosed M6x10 screws and washers.

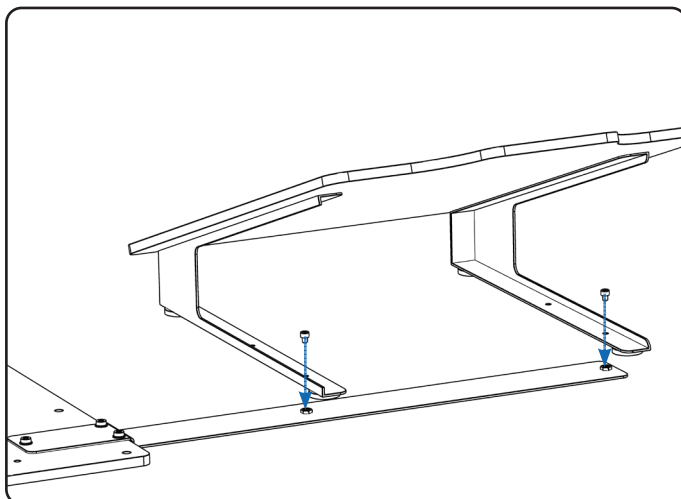

STEP3 (Backview)
Fix the HoopMaster with the help of the enclosed M5x6 screws to the connection.

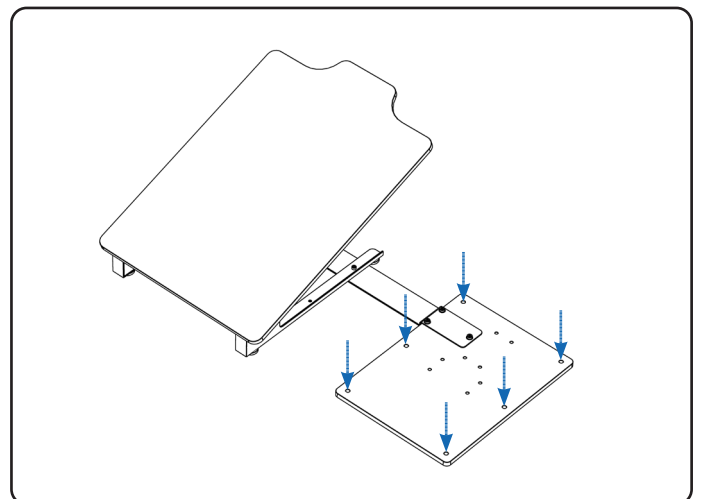

STEP4
IMPORTANT: Align the present assembly and screw it to the table top with the indicated holes to prevent it from tipping over! Screws are not included.



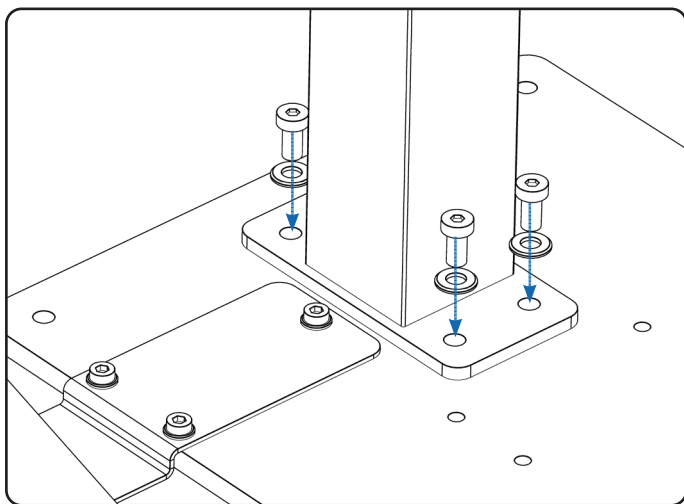

STEP5

Screw the tube with flange and 4 enclosed M8x16 onto the base plate.

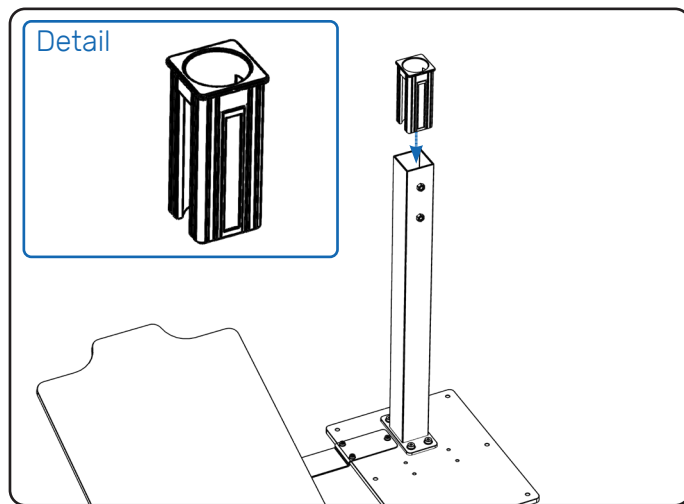

STEP6

Insert the plastic guide into the tube with the flexible tab facing towards the welded nuts.

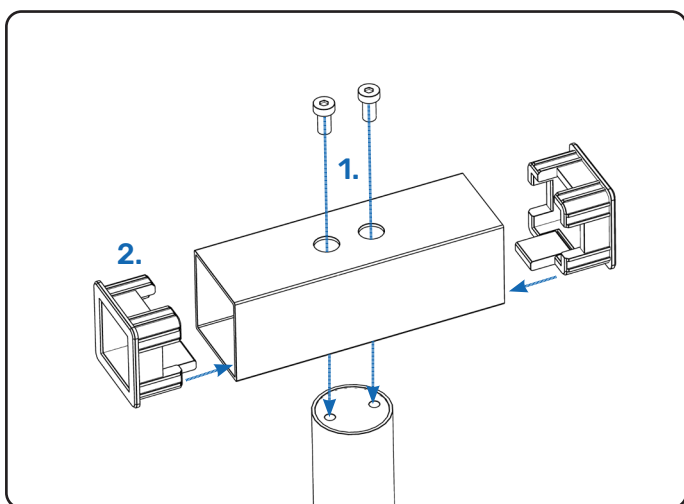

STEP7

Screw the square tube to the cylindrical tube using M8x16 screws. Insert the plastic guides into the tube with the flexible tab facing towards the welded nuts.

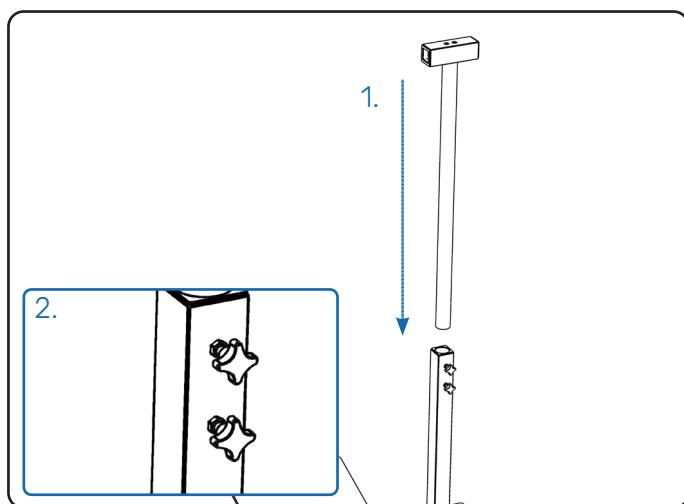

STEP8

Insert the pre-assembled T-shape into the pre-assembled base. In the second step use 2 cross handle screws for clamping.

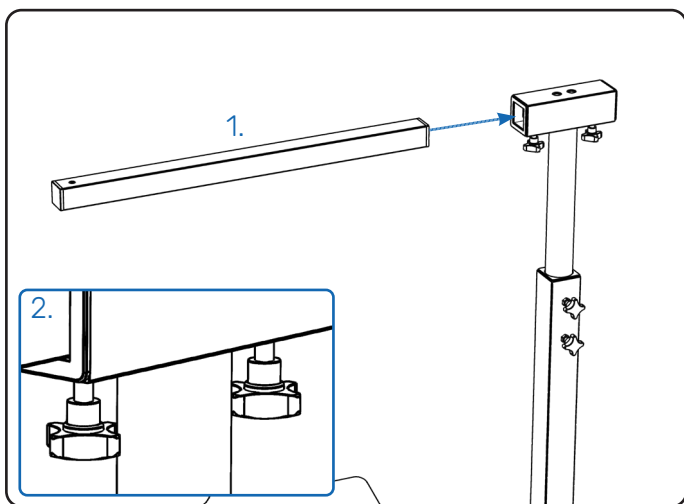

STEP9

First cover the 40x40mm tube with lamellar plugs and insert it into the T-shape as indicated. In the second step use 2 cross handle screws for clamping.

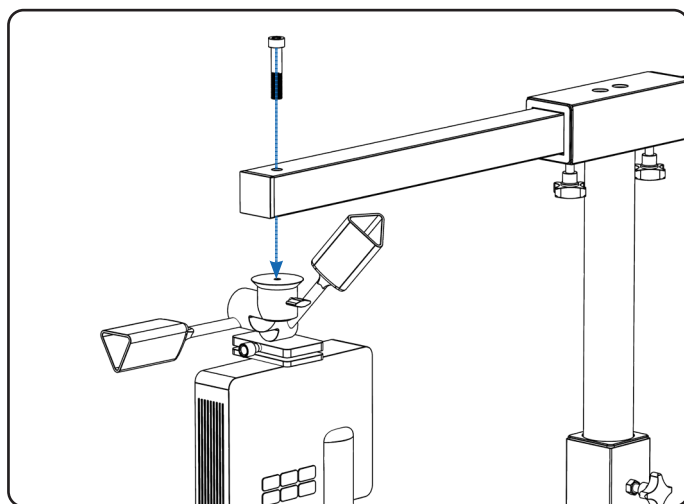

STEP10

Attach the tripod head and the beamer with the enclosed. 3/8"x2" screw.